

END ELEVATION
Kudos cowl & existing chimney cap
SCALE 1 : 10

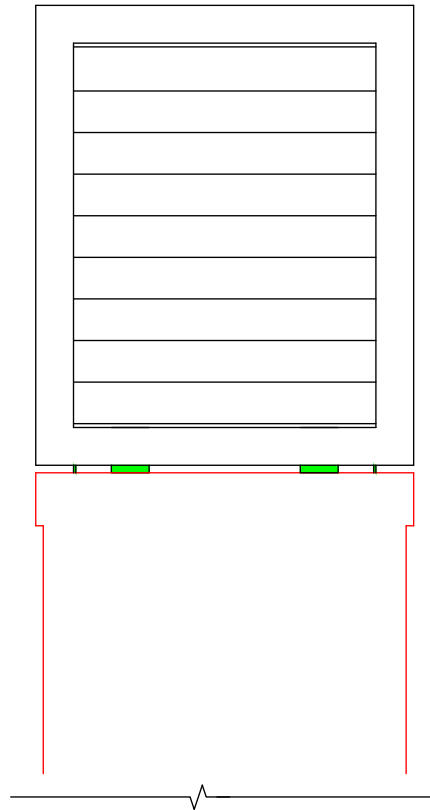

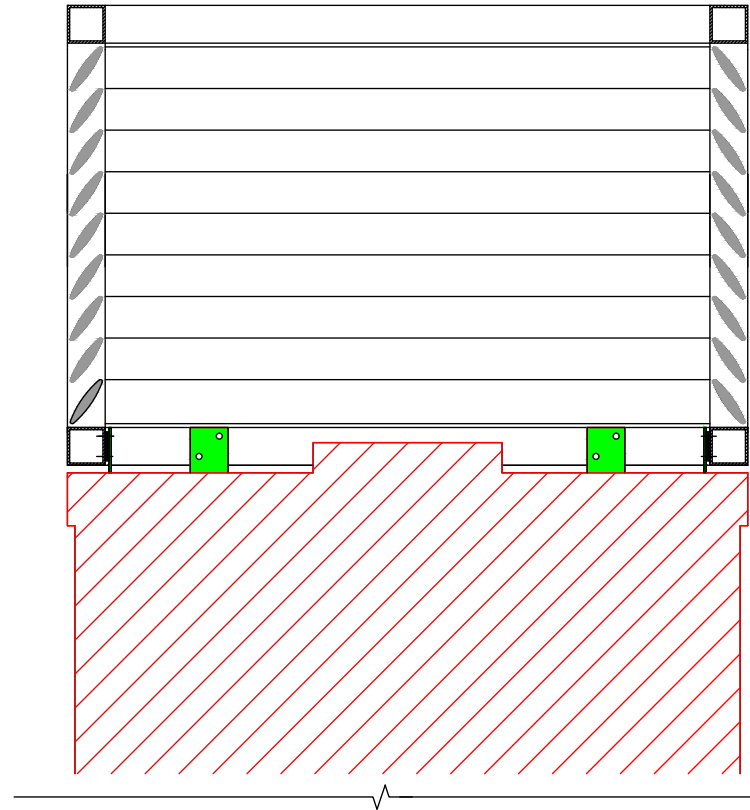

SECTION A-A
Through Kudos cowl & existing chimney cap

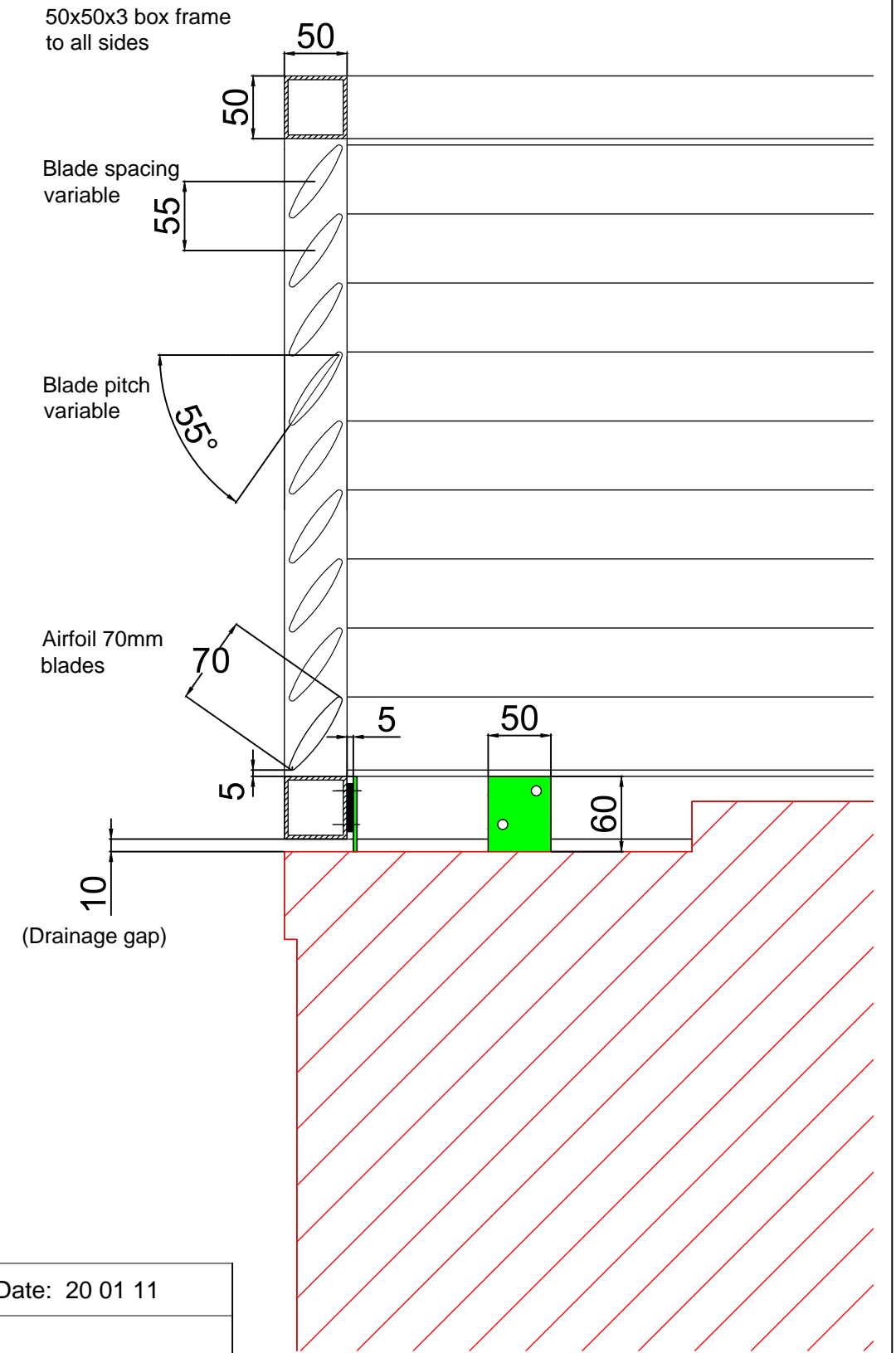

FIXING DETAIL
Kudos cowl to existing chimney cap
SCALE 1 : 5



-  3mm steel fixing tabs welded to existing chimney cap (ensures fixings avoid piercing the chimney cap)
-  Existing stainless steel chimney cap.
-  5mm plastic spacers, allow accurate adjustment at fixing and water drain-away.

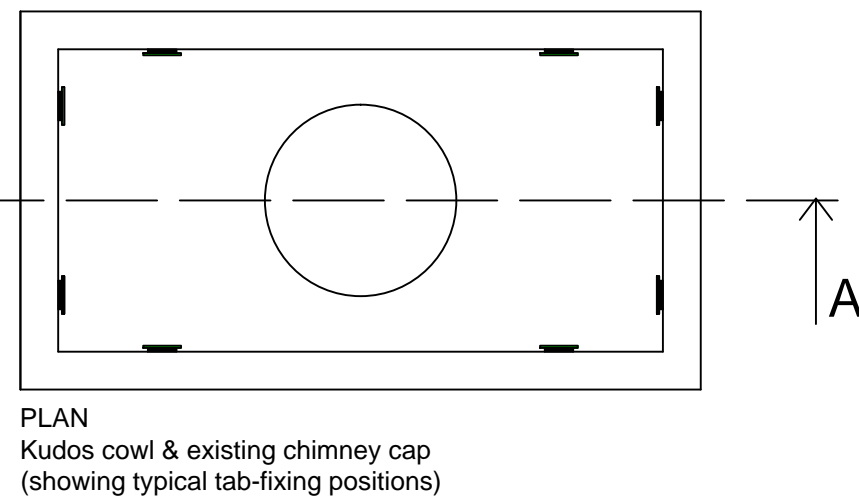

e. kudoslouvres@xtra.co.nz
w. www.kudoslouvres.co.nz
p. PO Box 35810, Browns Bay, Auckland 0753
Mob: 0274729857

Client: Hulena Architects
Chimney Cowl Details
Job No:

Drawing Date: 20 01 11
Rev No:
Scale: 1 : 10 & 1 : 5 @ A3